

# CAUTION

Read these instructions carefully before assembly and use and keep for future reference. The child may be hurt if you do not follow these instructions.

## WARNING:

The walker is not intended for babies that can already walk unassisted.

## WARNING:

Do not use the walker if it is damaged or broken.

## WARNING:

Do not use until the baby can sit upright by itself.

## WARNING:

Clean friction components regularly to maintain stopping performance.

## WARNING:

Never leave the child unattended. Always keep child in view while in walker.

## WARNING:

Use only on flat surfaces free of objects that could cause the walker to tip over.

## WARNING:

To avoid burns, keep the child away from hot liquids, ranges, radiators, space heaters, fire places etc.

## WARNING - STAIR HAZARD:

Avoid serious injury or death. Block stairs/steps securely before using walker.

- Adult assembly required.
- Read all instructions before assembly and use of the product.
- This baby walking frame is intended to be used by children who can sit unaided, approximately from 6 months. It is not intended for children weighing more than 12kg and/or more than 78cm in height.
- Take care when unpacking and during assembly.
- Dispose of all packaging materials carefully after assembly.
- Regularly check that all fittings remain tight. Tighten if required.
- Inspect the product before assembly and periodically during use. Never use this product if there is any loose or missing fasteners, joints or broken parts.
- Any additional or replacement parts should only be obtained from the manufacturer or distributor.
- Never substitute parts.

### CARE AND MAINTENANCE:

- All assembly fittings are to be properly tightened. Inspect regularly and re-tighten as necessary.
- To clean the seat pad, removable and non-removable fabric covers may be hand washed or spot cleaned. Use mild soap or upholstery shampoo. Wash separately. Do not bleach. Dry in shade thoroughly before re-use and avoid direct heat and sunlight. Do not iron. Do not dry clean. ☒
- To clean the walker, wipe with a damp cloth and dry immediately with a soft clean cloth. Do not use abrasive pads, bleach or strong household cleaners. Damage may result.

6-12 months

# anko

## WANDERER WALKER INSTRUCTION MANUAL

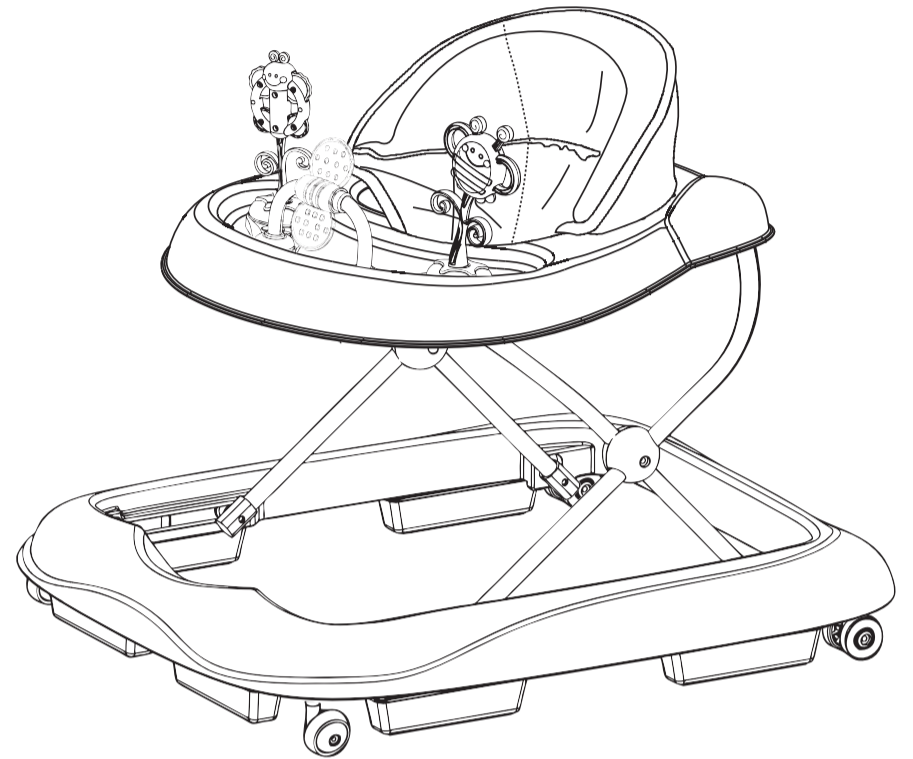

Drawings in the manual are for visual purposes only. Actual product may vary slightly. The manufacturer reserves the right to change any specification or feature without prior notice.

Read these instructions carefully before use and keep for future reference. The child may be hurt if you do not follow these instructions.

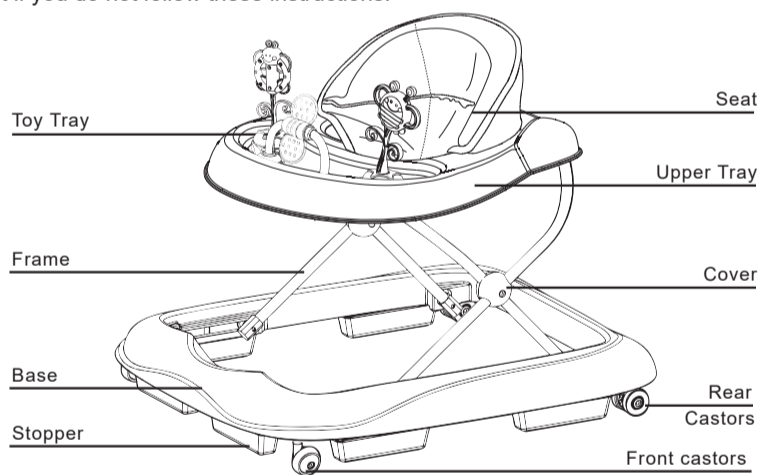

### Assemble

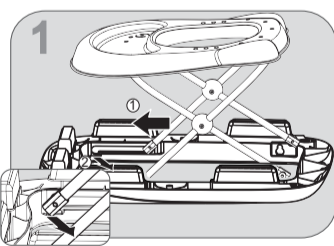

1 Remove base and frame from carton and extend tray from base. The base will be upside down and wrong way around. Remove base from the frame by detaching the frame from the frame runners positioned in the base in addition to removing the cable ties.

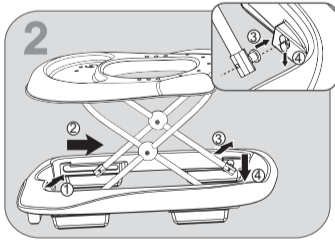

2 Turn the base correct way up and facing correct way. Insert the front 2 arms of the frame into the frame runners positioned at the front of the base. Using the folding adjustor situated under the tray, turn the lever and let the walker fold down. Then insert the back frame arms into the "8" shaped hole at the back of the base on either side.

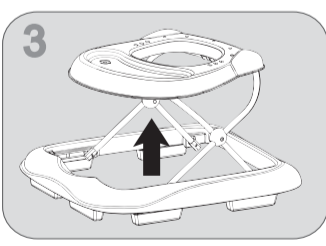

3 To unfold the walker, simply pull the upper tray to the upright position. To fold, simply turn the lever under the tray.

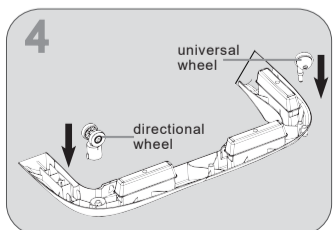

4 Place the base of the walker on a flat surface, with the bottom facing up. Insert rear and front castors into corresponding openings by pressing and snapping into positions. Note: once fitted, pull on castors to ensure it is securely attached.

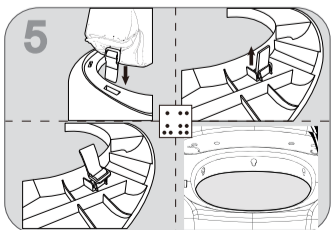

5 Position the seat on the frame and attach it by inserting the tabs into the corresponding holes. Make sure to insert the tabs on sides first, and then insert the tabs in center. Make sure you have installed the seat correctly.

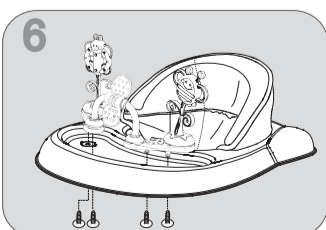

6 Attach toys to the corresponding holes on the tray and secure with the screws.

### User guide

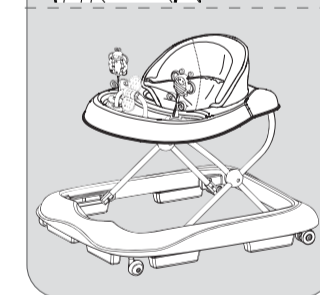
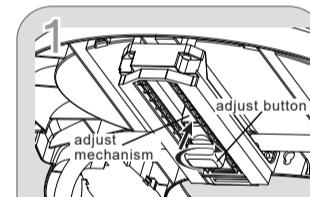

1 Lift the tray up to the desired height and make sure the locking device is engaged.

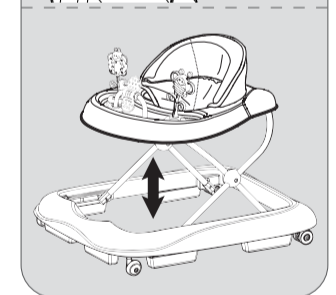
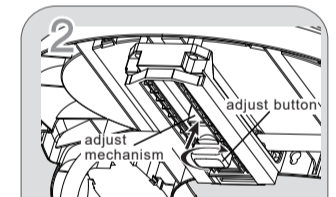

2 To adjust the height to the upper position, pull the upper tray to the height you require. To adjust the height to the lower position, turn the adjustment button 90 degrees and press the button upward to release the lock, then press the tray to the required position. Warning: Please make sure the baby is not in the walker when you adjust height and make sure the adjustment mechanism is locked before use.

Keycode: 42223245

MADE IN CHINA

©KMART AUSTRALIA LIMITED

ANKO, KIDS&CO. AND BABY SOLUTIONS ARE ALL TRADEMARKS OF KMART AUSTRALIA LIMITED. THEY ARE USED IN NEW ZEALAND BY KMART NZ HOLDINGS LIMITED TRADING AS KMART IN NEW ZEALAND.

KMART AUSTRALIA - 690 SPRINGVALE RD, MULGRAVE, VIC 3170 AUSTRALIA.

KMART NEW ZEALAND - REGIONAL OFFICE C/O KMART PAPATOETOE STORE HUNTERS PLAZA, GREAT SOUTH RD, PAPATOETOE, AUCKLAND, NEW ZEALAND.